

Protective sliders
HONDA CBR 600 RR

Year of production: '09-
 Product code: 10121

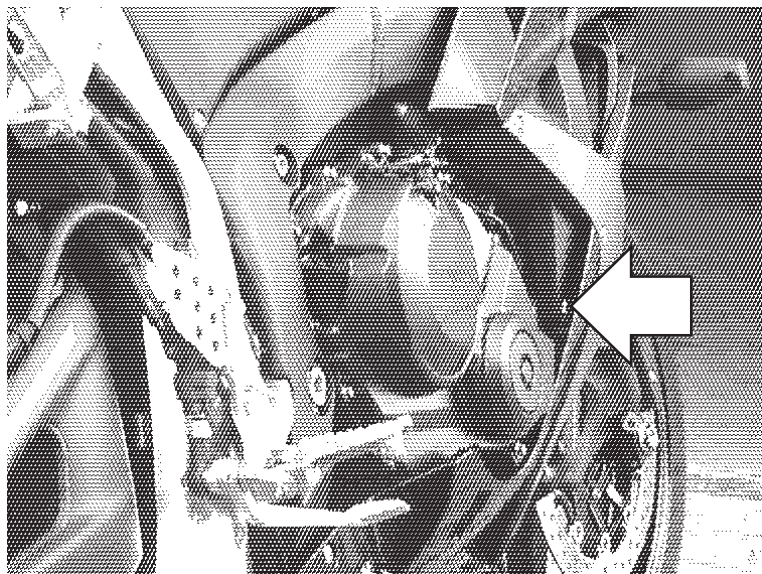

Assembly position
 (both sides)

Assembly instructions

1. Remove the screws indicated with the arrows.
2. Remove the original Honda sleeves which are originally placed between the frame and the engine body.
3. Replace the removed original Honda sleeves with the metal bars (parts #3) according to the attached drawing. Put the metal bars (parts #3) in the right positions according to the drawing.
4. Assemble the metal bars (parts #3) using the original Honda screws.
5. Assemble the sliders and the screws according to the drawing (parts #1, #2, #4, #5).
6. Assemble the screws #4 and the sliders with the metal bars #3.

We suggest to use the threadlocker to make sure that the screws do not get loose.

This product is entirely produced in the European Union. This product is a professional accessory to be used on the race track. Renner LTD takes no responsibility for any damages occurred despite of using protective accessories. For more information go to www.renner-moto.com

Assembly scheme (both sides)

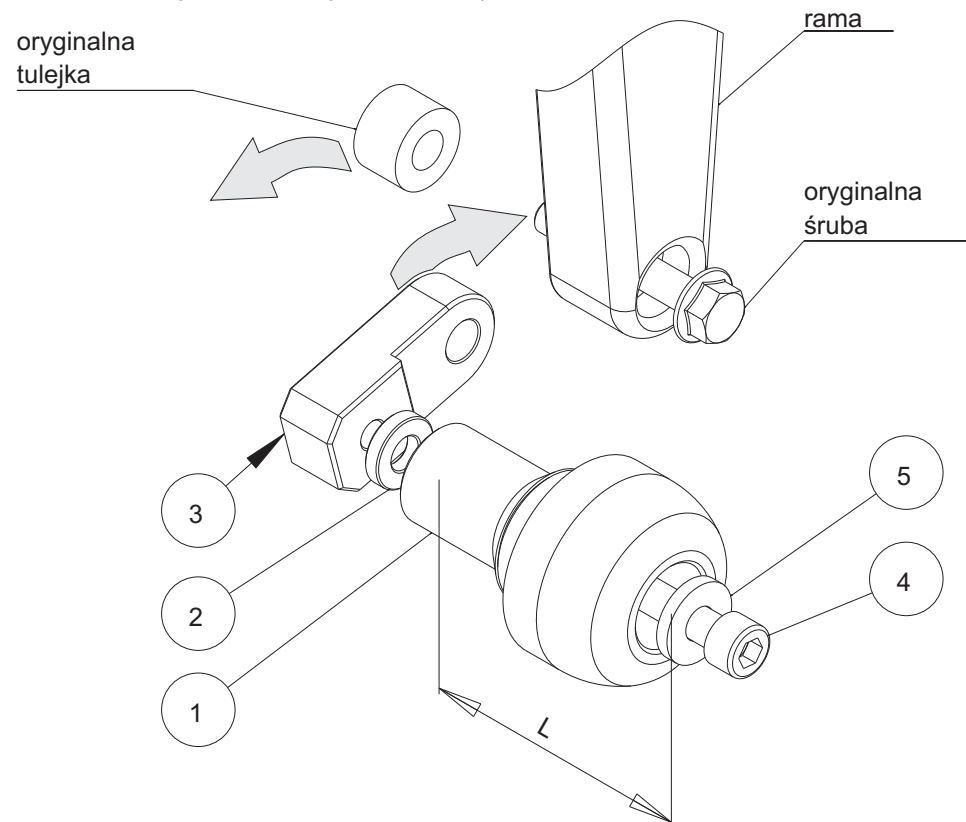

No	Part	Left Side	Right Side
1	Slider	L = 100 mm	L = 90 mm
2	Sleeve		
3	Metal bar		
4	Screw	M10	M10
5	Washer		