

Crash Pads
Honda CB 650 F
Year of Production: all
Product Code: 10133

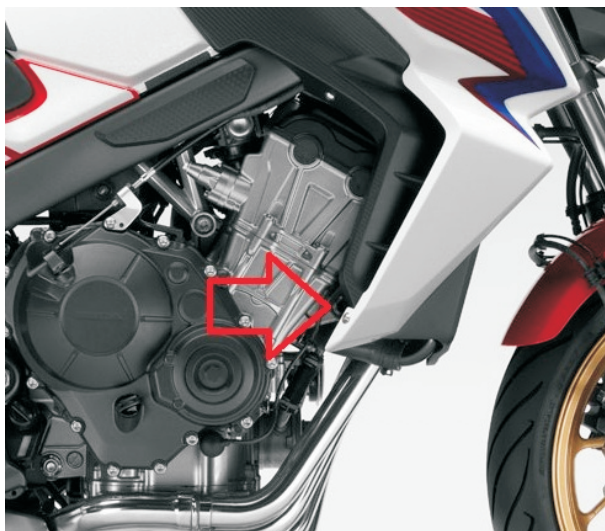

Assembly position
(both sides)

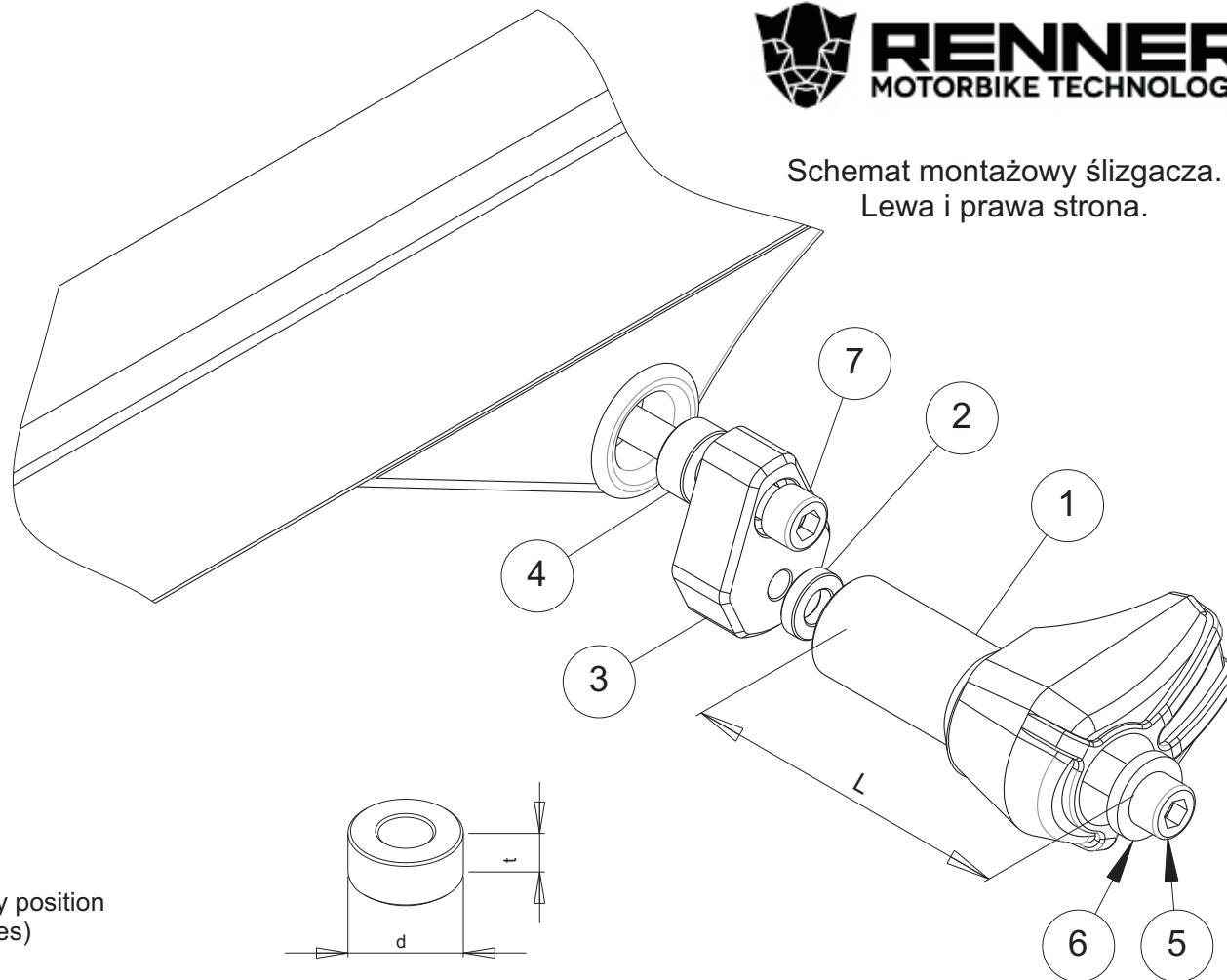

Schemat montażowy ślizgacza.
Lewa i prawa strona.

Assembly instructions

1. Remove the screws indicated with the arrows.
2. Replace the removed screws by the new screws (parts #4) and metal bars (parts #3) according to the attached drawing. Put the metal parts (parts #3) in the right positions according to the drawing.
3. Assemble the sliders and the screws according to the drawing (parts #1, #2, #6, #7).
4. Assemble the screws #7 and the sliders with the metal bars #3.

We suggest to use the threadlocker to make sure that the screws do not get loose.

This product is entirely produced in the European Union. This product is a professional accessory to be used on the race track. Renner LTD takes no responsibility for any damages occurred despite of using protective accessories. For more information go to www.renner-moto.com

No	PART	LEFT SIDE	RIGHT SIDE
1	SLIDER		
2	SLEEVE	d=20 mm, t=5 mm	d=20 mm, t=5 mm
3	ALUMINIUM BAR		
4	SLEEVE	d=22 mm, t=10 mm	d=22 mm, t=10 mm
5	BOLT	M10	M10
6	WASHER		
7	MAIN BOLT	M12X80 mm	M12X60 mm