

Protective sliders
KAWASAKI Z 750/1000
Year of production: '07 -
Product code: 10210

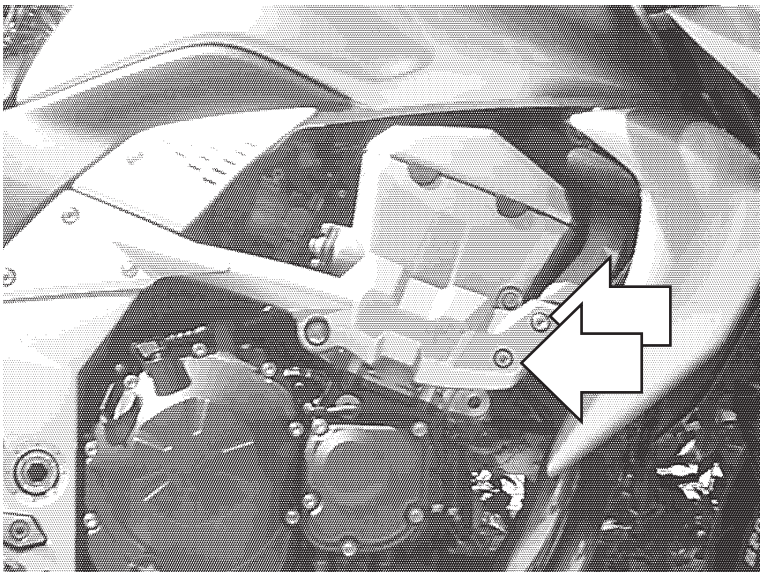

Assembly position
(both sides)

Assembly instructions

1. Remove the screws indicated with the arrows.
2. Replace the removed screws with the new screws (parts #7), aluminium sleeves (parts #4) and metal bars (parts #3) according to the attached drawing. Put the metal bars (parts #3) in the right positions according to the drawing.
3. Assemble the sliders and the screws according to the drawing (parts #1, #2, #5, #6).
4. Assemble the screws #5 and the sliders with the metal bars #3.

We suggest to use the threadlocker to make sure that the screws do not get loose.

This product is entirely produced in the European Union. This product is a professional accessory to be used on the race track. Renner LTD takes no responsibility for any damages occurred despite of using protective accessories. For more information go to www.renner-moto.com

Assembly scheme (both sides)

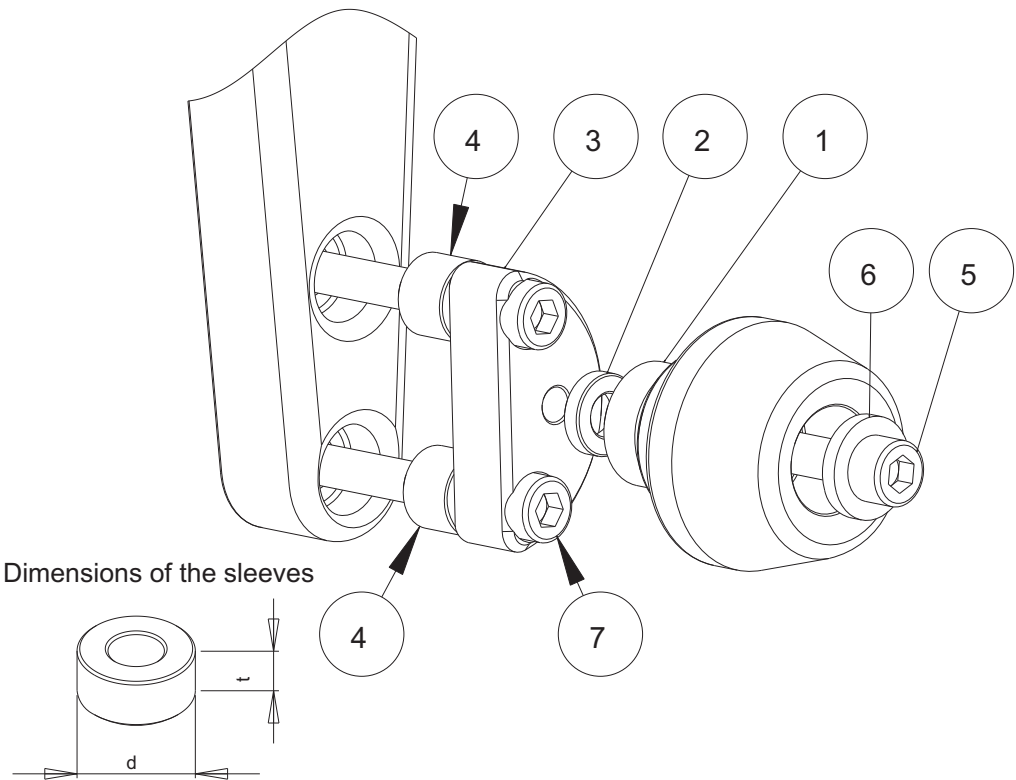

| NO | PART | LEFT SIDE | RIGHT SIDE |
|----|--------|------------------|------------------|
| 1 | Slider | L = 65 mm | L = 55 mm |
| 2 | Sleeve | d=20 mm, t=5 mm | d=20 mm, t=5 mm |
| 3 | Bar | | |
| 4 | Sleeve | d=14 mm, t=10 mm | d=14 mm, t=10 mm |
| 5 | Screw | M10 | M10 |
| 6 | Washer | | |
| 7 | Screw | M8 | M8 |