

**Protective sliders  
BMW S 1000 RR**

Year of production: ALL  
Product code: 10502

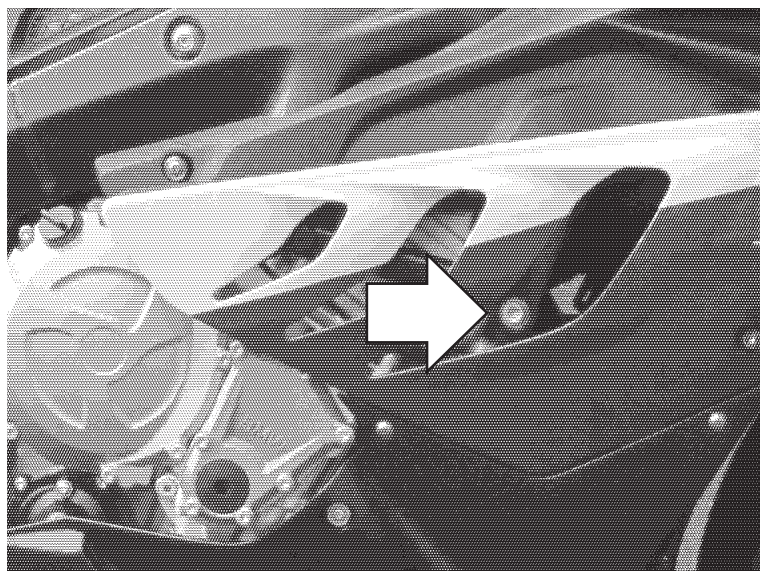

Assembly positions.  
Left and right sides

**Assembly instructions**

1. Remove the screws indicated with the arrows.
2. Replace the removed screws by the new screws (parts #4) and metal bars (parts #2) according to the attached drawing. Put the metal parts (parts #2) in the right positions according to the drawing.
3. Assemble the sliders and the screws according to the drawing (parts #1, #6, #5).
4. Assemble the screws #5 and the sliders with the metal bars #2.

We suggest to use the threadlocker to make sure that the screws do not get loose.

This product is entirely produced in the European Union. This product is a professional accessory to be used on the race track. Renner LTD takes no responsibility for any damages occurred despite of using protective accessories. For more information go to [www.renner-moto.com](http://www.renner-moto.com)

Assembly scheme (both sides)

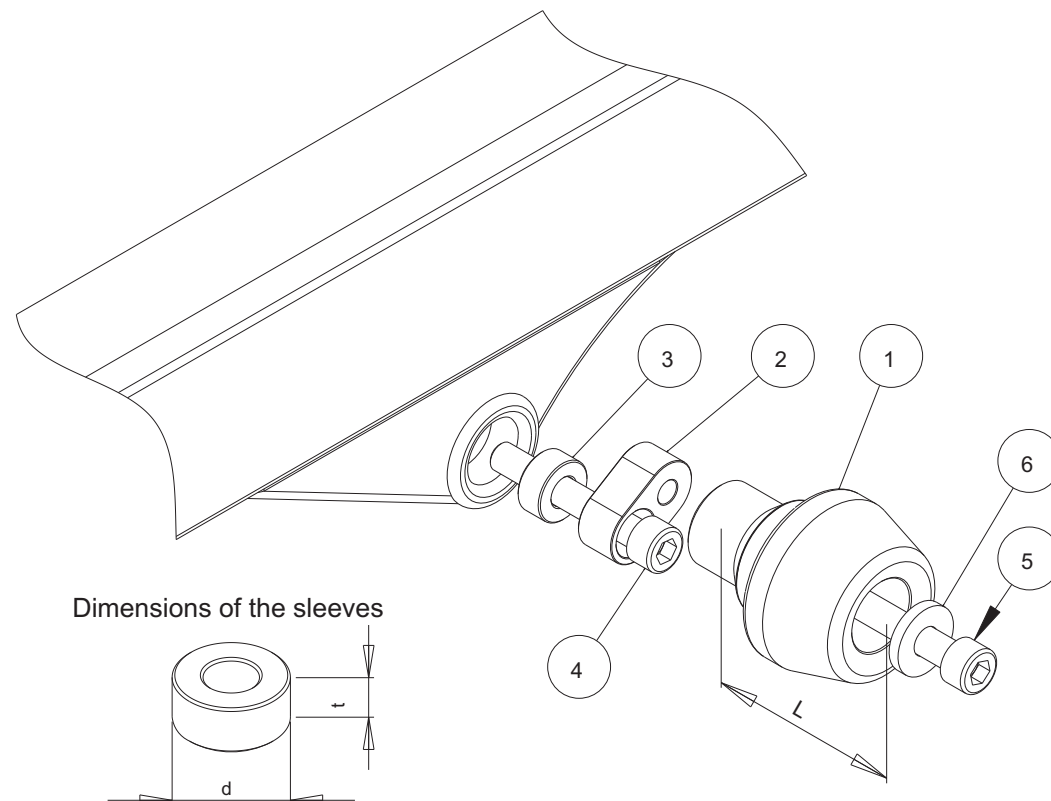

No	Part	Left side	Right side
1	Slider	L = 65 mm	L = 55 mm
2	Metal bar		
3	Sleeve		
4	Main screw	M10, l = 65 mm	M10, l = 65 mm
5	Screw	M10	M10
6	Washer		