

**Protective sliders  
BMW S 1000 R**

Year of production: All  
Product code: 10508

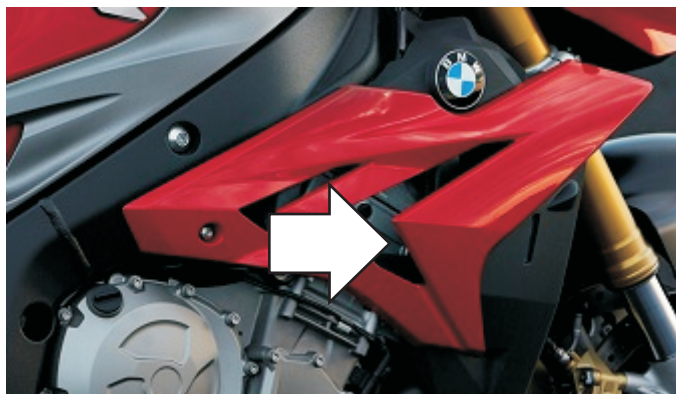

Assembly positions.  
Left and right sides

**Assembly instructions**

1. Please note that the sliders are not simmetrical on both sides. This is to avoid drilling in the fairings. The left slider goes in front of the fairing. The right one goes in the hole in the fairing.
2. Remove the screws indicated with the arrows.
3. Replace the removed screws by the new screws (parts #4) and metal bars (parts #2) according to the attached drawing. Put the metal parts (parts #2) in the right positions according to the drawing.
3. Assemble the sliders and the screws according to the drawing (parts #1, #6, #5).
5. Assemble the screws #5 and the sliders with the metal bars #2.

We suggest to use the threadlocker to make sure that the screws do not get loose.

This product is entirely produced in the European Union. This product is a professional accessory to be used on the race track. Renner LTD takes no responsibility for any damages occurred despite of using protective accessories. For more information go to [www.renner-moto.com](http://www.renner-moto.com)

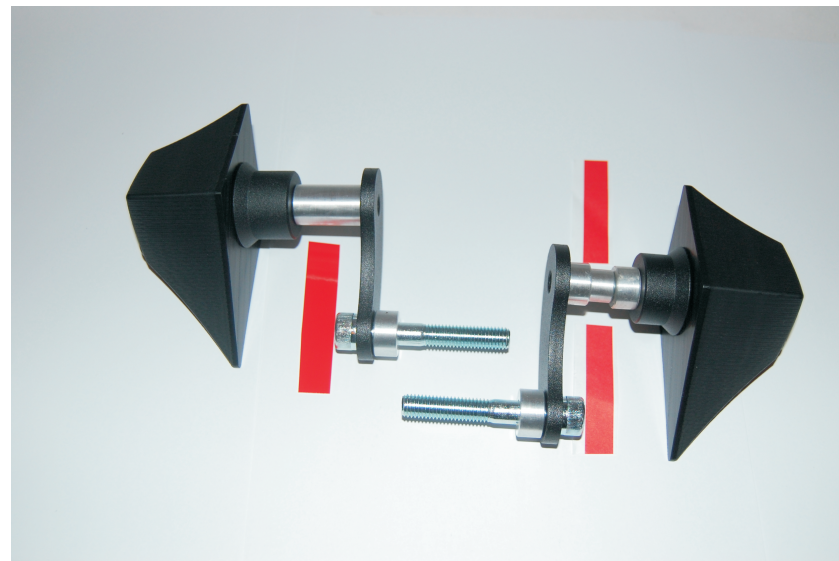

Dimensions of the sleeves

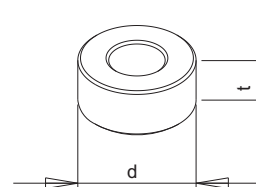

Assembly scheme (both sides)  
RED LINES INDICATE THE FAIRINGS

No	Part	Left side	Right side
1	Slider	L = 65 mm	L = 55 mm
2	Metal bar		
3	Sleeve		
4	Main screw	M10, l65 mm	M10, l65 mm
5	Screw	M10	M10
6	Washer		