

Protective sliders
KAWASAKI ZX 6 R/RR

Year of production: '05 - '06

Product code: 10203

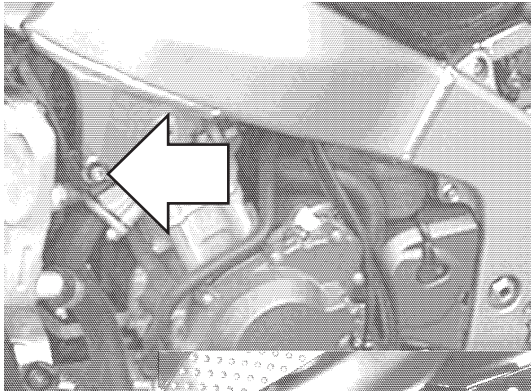

Assembly position (left side)

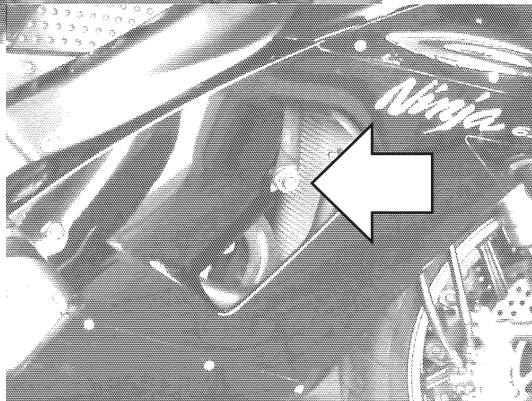

Assembly position (right side)

Assembly instructions

1. Remove the screws indicated with the arrows.
2. Replace the removed screws with the new screws (parts #7), aluminium sleeve (part #4 - only on the left side) and metal bars (parts #3) according to the attached drawing. Put the metal bars (parts #3) in the right positions according to the drawing.
3. Assemble the sliders and the screws according to the drawing (parts #1, #2 - only on the left side, #5, #6).
4. Assemble the screws #5 and the sliders with the metal bars #3.

We suggest to use the threadlocker to make sure that the screws do not get loose.

This product is entirely produced in the European Union. This product is a professional accessory to be used on the race track. Renner LTD takes no responsibility for any damages occurred despite of using protective accessories. For more information go to www.renner-moto.com

Assembly scheme (both sides)

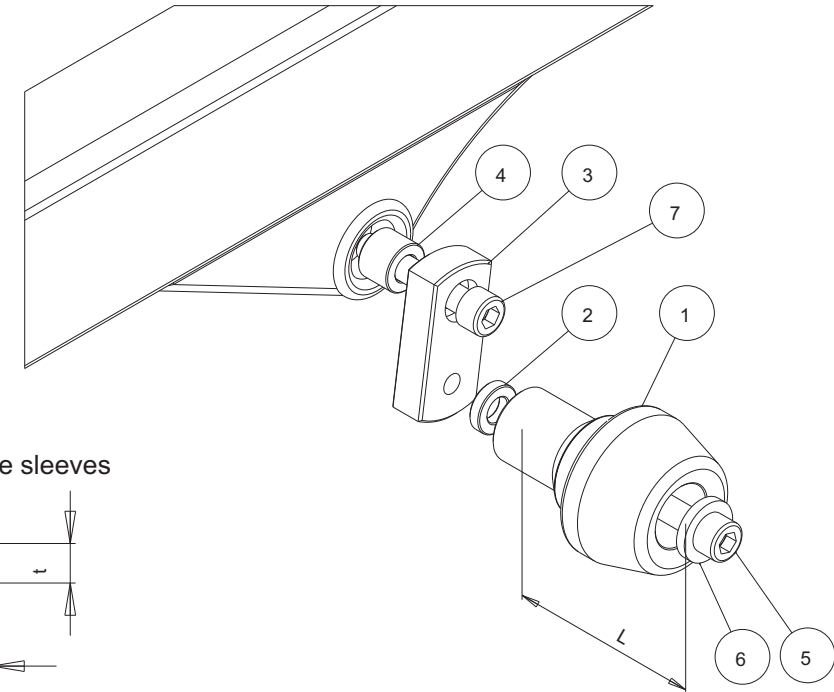

Dimensions of the sleeves

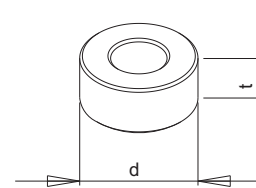

| NO | PART | LEFT SIDE | RIGHT SIDE |
|----|--------|------------------|-----------------|
| 1 | Slider | L = 95 mm | L = 65 mm |
| 2 | Sleeve | d=20 mm, t=5 mm | d=20 mm, t=5 mm |
| 3 | Bar | alu (long) | steel (short) |
| 4 | Sleeve | d=20 mm, t=15 mm | NOT IN THIS SET |
| 5 | Screw | M10 | M10 |
| 6 | Washer | | |
| 7 | Screw | M10, l = 80 mm | M10, l = 90 mm |