

# 10505

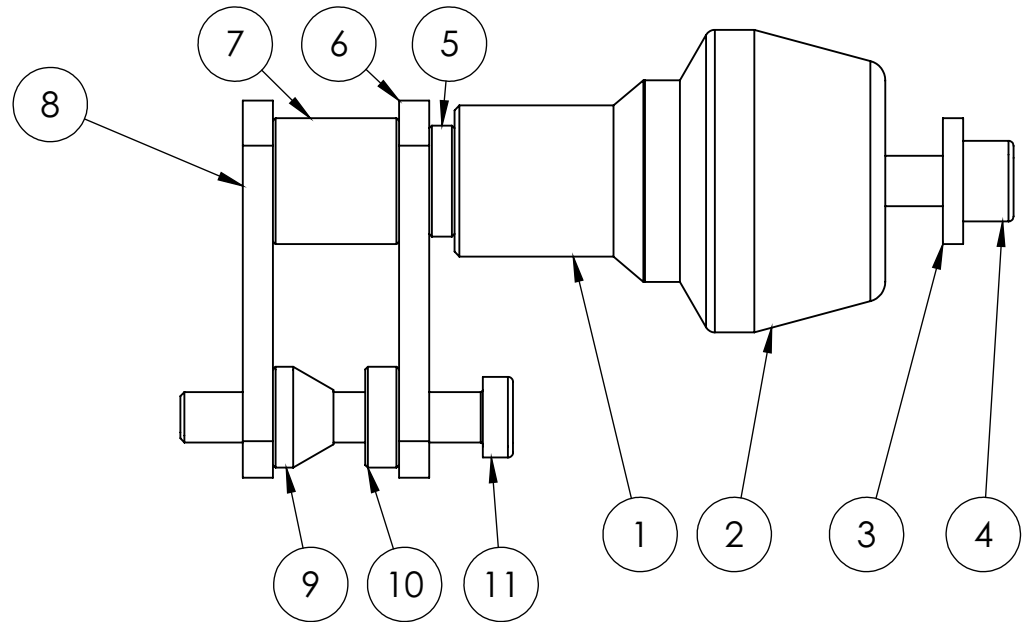
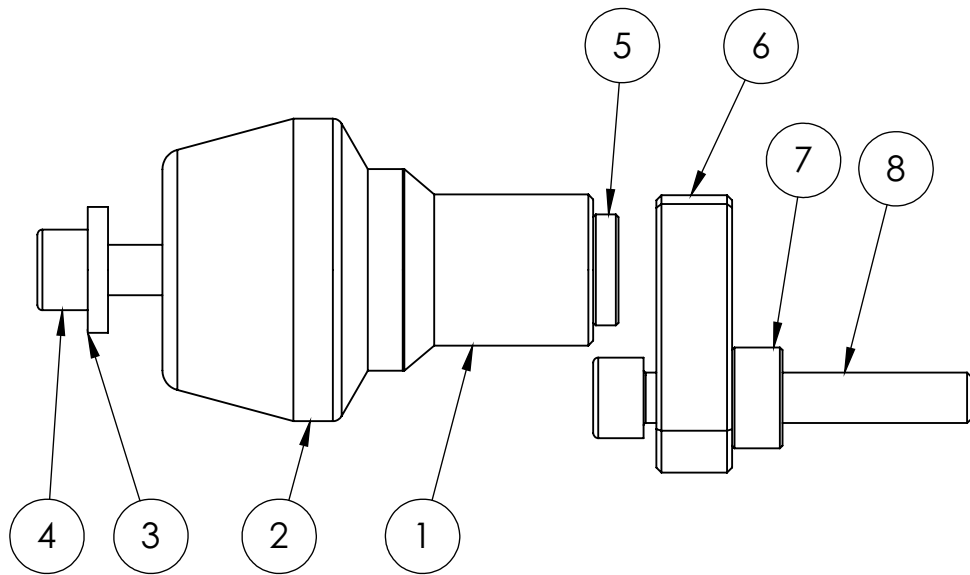

No	Part code		
1	A-30x60		1
2	PAD60-2		1
3	DIN 7349-10.5-St		1
4	DIN 912 M10 x 80 --- 32N		1
5	TU-22x5_10		1
6	P-55x30x15-1		1
7	TU-20x10-10		1
8	DIN 912 M10 x 65 --- 32N	12,9	1

No	Part code		
1	A-30x60		1
2	PAD60-2		1
3	DIN 7349-10.5-St		1
4	DIN 912 M10 x 110 -- - 36N		1
5	TU-22x5_10		1
6	B4015		1
7	TU-25x25-10		1
8	B4002		1
9	TU		1
10	TU-20x6,7-10		1
11	DIN 7984 - M10 x 60 --- 26N	ewentualnie ISO7380, 10.9	1